

# SPACING RULES FOR SIDEWALLS?

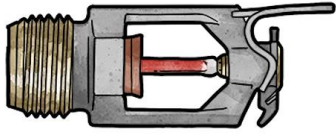

M

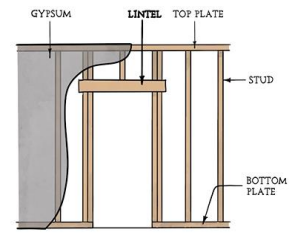
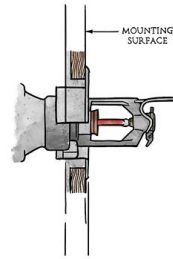

M

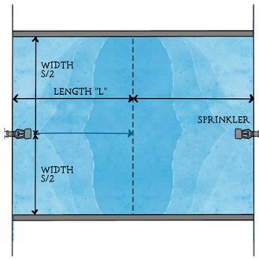
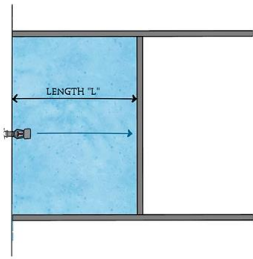

M

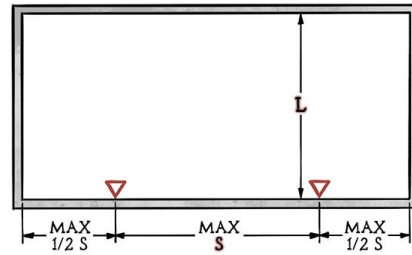

M

## NOTES

A large area of dotted lines for taking notes.

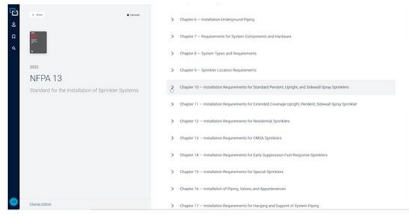

NFPA LINK® USED WITH PERMISSION. SEE LINK BELOW



The protection area of the sprinkler shall be established by multiplying the S dimension by the L dimension, as follows:

$$A_p = S \times L \quad (10.3.3.2)$$

10.3.3.2 Maximum Protection Area of Coverage.

10.3.3.2.1

D Pin Header

Table 10.3.3.2.1 Protection Areas and Maximum Spacing (Standard Sidewall Spray Sprinkler)

	Light Hazard		Ordinary Hazard	
	Combustible Ceiling Finish	Noncombustible or Limited-Combustible Ceiling Finish	Combustible Ceiling Finish	Noncombustible or Limited-Combustible Ceiling Finish
Maximum distance along the wall (S) (ft) [m]	14 [4.3]	14 [4.3]	10 [3.0]	10 [3.0]
Maximum room width (L) (ft) [m]	12 [3.7]	14 [4.3]	10 [3.0]	10 [3.0]
Maximum protection area (ft <sup>2</sup> ) [m <sup>2</sup> ]	120 [11]	196 [18]	100 [9.3]	100 [9.3]

Maximum protection area (ft<sup>2</sup>) [m<sup>2</sup>]: 120 [11] / 196 [18]

10.3.3.2.2

In any case, the maximum area of coverage of a sprinkler shall not exceed 196 ft<sup>2</sup> (18 m<sup>2</sup>).

MEYERFIRE UNIVERSITY



$S = \text{MAX OF } (S-S) \text{ OR } 2(S-W)$   
 $S = 14\text{-ft } (4.3 \text{ m})$   
 $L = 12\text{-ft } (3.7 \text{ m})$   
 $A = 14\text{-ft} \times 12\text{-ft } (4.3 \text{ m} \times 3.7 \text{ m}) = 168 \text{ sqft } (15.6 \text{ sqm})$

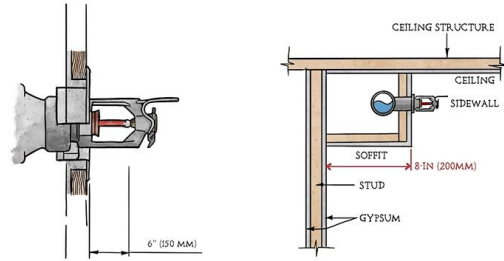
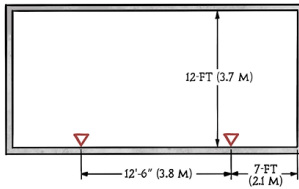

NOTES

Grid of dots for handwritten notes.