

HEIGHT OF PENDENTS & UPRIGHTS: OBSTRUCTED

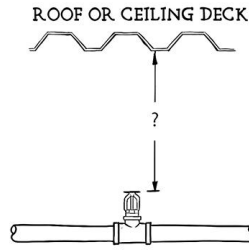
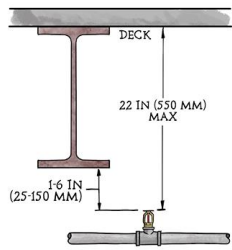

M

10.2.6.1.2 Obstructed Construction

Under obstructed construction, the sprinkler deflector shall be located in accordance with one of the following arrangements:

- (1) Installed with the deflectors within the horizontal planes of 1 in. to 6 in. (25 mm to 150 mm) below the structural members and a maximum distance of 22 in. (550 mm) below the ceiling/roof deck.
- (2) Installed with the deflectors at or above the bottom of the structural member to a maximum of 22 in. (550 mm) below the ceiling/roof deck where the sprinkler is installed in conformance with 10.2.7.2
- (3) Installed in each bay of obstructed construction, with the deflectors located a minimum of 1 in. (25 mm) and a maximum of 12 in. (300 mm) below the ceiling.
- (4) Installed with the deflectors within the horizontal planes 1 in. to 6 in. (25 mm to 150 mm) below composite wood joists to a maximum distance of 22 in. (550 mm) below the ceiling/roof deck only where joist channels are fire-stopped to the full depth of the joists with material equivalent to the web construction so that individual channel areas do not exceed 300 ft² (28 m²).
- (5)* Installed with deflectors of sprinklers under concrete tee construction with stems spaced less than 7 1/2 ft (2.3 m) on centers, regardless of the depth of the tee, located at or above a horizontal plane 1 in. (25 mm) below the bottom of the stems of the tees and complying with Table 10.2.7.2(a) or Table 10.2.7.2(b).

M

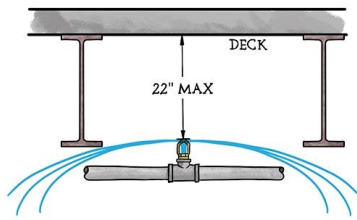
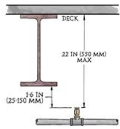

M

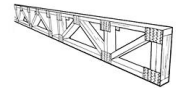
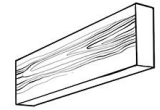
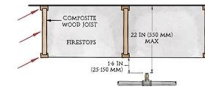

M

NOTES

Grid of dots for notes.

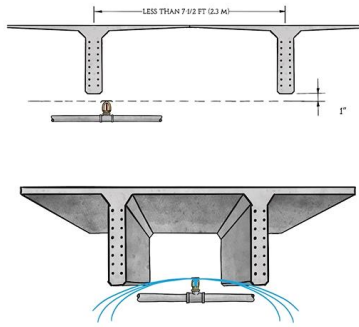
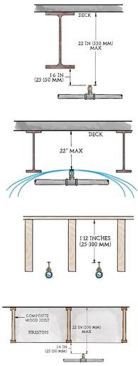

- IBC 2024 EDITION, WHICH REFERENCES NFPA 13-2022
- NFPA 13-2022 EDITION
- CHAPTER 10 REQUIREMENTS FOR STANDARD SPRAY SPRINKLERS
- SECTION 10.2 PENDENTS AND UPRIGHTS
- SECTION 10.2.6 COVERS DEFLECTOR POSITION
- SECTION 10.2.6.1 COVERS DISTANCE BELOW CEILINGS
- SECTION 10.2.6.1.2 COVERS OBSTRUCTED CONSTRUCTION
- SECTION 10.2.6.1.2(1) OBSTRUCTED CONSTRUCTION HEIGHT FOR SPRINKLER

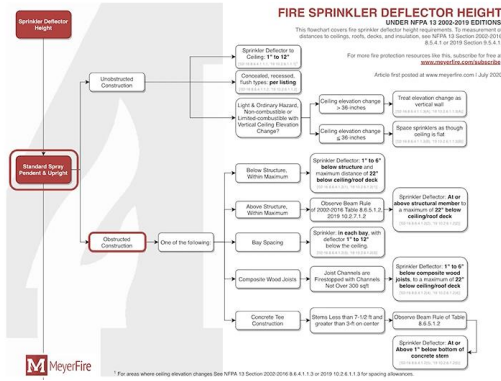
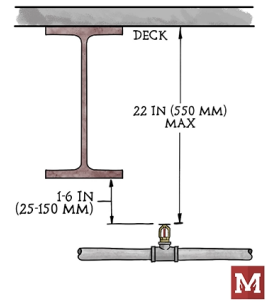

THE CORRECT DEFLECTOR HEIGHT FOR PENDENTS & UPRIGHTS IN OBSTRUCTED CONSTRUCTION

- 1 GENERAL RULE
(1-6 INCHES, 22-INCHES / 25-150, 550 MM)
- 2 OBSERVE OBSTRUCTIONS RULES
- 3 SPRINKLER IN EACH BAY
- 4 COMPOSITE WOOD JOISTS
- 5 CONCRETE TEE CONSTRUCTION

NOTES

Grid area for notes.