

LAYOUT EXAMPLE: AMBULANCE BAY, PART I

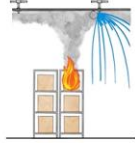

M

M

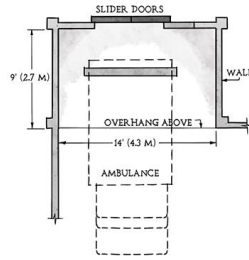
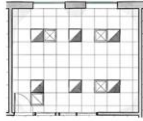
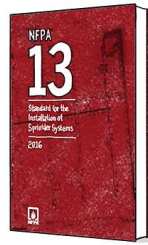
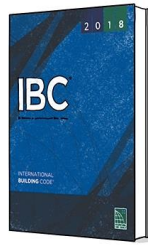
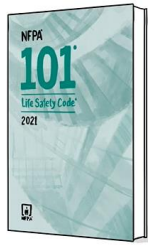

M

© 2016 NFPA 13 | Chapter 8 - Installation Requirements

8.15.2* Exterior Projections.

8.15.2.1
Unless the requirements of **8.15.2.2**, **8.15.2.3**, or **8.15.2.4** are met, sprinklers shall be installed under exterior projections exceeding 4 ft (1.2 m) in width.

8.15.2.2*
Sprinklers shall be permitted to be omitted where the exterior canopies, roofs, porte-cochères, balconies, decks, and similar projections are constructed with materials that are noncombustible, limited-combustible, or fire-retardant-treated wood as defined in NFPA 703, or where the projections are constructed utilizing a noncombustible frame, limited-combustibles, or fire-retardant-treated wood with an inherently flame-resistant fabric overlay as demonstrated by Test Method 2 in accordance with NFPA 701.

8.15.2.3
Sprinklers shall be permitted to be omitted from below the exterior projections of combustible construction, provided the exposed finish material on the exterior projections are noncombustible, limited-combustible, or fire-retardant-treated wood as defined in NFPA 703, and the exterior projections contain only sprinklered concealed spaces or any of the following unsprinklered concealed spaces:

- (1) Combustible concealed spaces filled entirely with noncombustible insulation
- (2) Light or ordinary hazard occupancies where noncombustible or limited-combustible ceilings are directly attached to the bottom of solid wood joists so as to create enclosed joist spaces 160 ft² (4.5 m²) or less in volume, including space below insulation that is fast directly on top or within the ceiling joists in an otherwise sprinklered attic [see **11.2.2.3.4.6(5)**]
- (3) Concealed spaces over isolated small exterior projections not exceeding 55 ft² (5.1 m²) in area

M

NOTES

A large grid area for taking notes, consisting of a series of small squares.

Blog | Forum | The Toolkit | University | PE Exam | Login | Pricing | The Code | Cart

Sprinkler Concealed Space if Minimal Wood?

8/26/2022 0 Comments

The building structure is permitted to be combustible construction per 1.2.2.50 of the National Building Code of Canada. For concealing the sprinkler system to be built with cast in place concrete columns and ducts, but need to use combustible studs for the minor partitions.

So far nothing wrong here. You're saying that the ceiling is 10 ft high, is also setting cast in place creating a concealed space for the duct and piping and studs. The ceiling and both the space of the minor combustible partition walls are to be provided inside the concealed space to the underside of the concrete slab.

The concealed space is made up of a concrete slab with the separations located to the underside of the slab containing any and everything without piping or concealed space with the other side.

Do the other hand the sprinkler gas pipes that the exposed 2x4 studs surface in the concealed space are not considered limited-combustion material, per NFPA 13 Section 9.2.3.1, and the space should be concealed or treat with non-combustible insulation?

Being that the building is permitted to be of combustible construction and the developer want above and beyond with the concrete structure, I'm not sure whether the space needs to be sprinkler protected or not.

Applying both the code and the building code, and if you have should it be protected?

Thank you.

Select an answer for this discussion: [Click Here to View / Submit Your Question / Suggest a Solution](#)

0 Comments

Does Reference in a Standard Pull in Other Code?

8/26/2022 0 Comments

This is a project involving many applications of tests and an exhaust system including multiple AHU's, exhaust ducts. This is a project in Ontario Canada, and the Ontario Building Code is applicable. Also other codes may need to be.

YOUR POST

[SUBMIT A QUESTION](#)

M

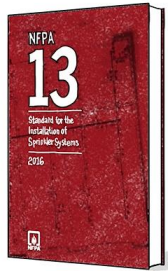
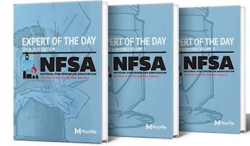

9.2.3 Exterior Projections.

9.2.3.1* Surfaces shall be permitted to be concealed where the exterior canopies, roofs, porte-cochères, balconies that are wood as defined in NFPA 703, or are frame, limited-combustibles, if fabric overlay as demonstrated.

Code

NFPA 13 - STANDARD FOR THE INSTALLATION OF SPRINKLER SYSTEMS (2022)

A.9.2.3.1 Vehicles that are temporarily parked are not considered storage. Areas located at drive-in bank windows or porte-cochères at hotels and motels normally do not require sprinklers where there is no occupancy above, where the area is entirely constructed of noncombustible or limited-combustible materials or fire retardant-treated lumber, and where the area is not the only means of egress.

[Add to Reference Panel](#) [Open in Book View](#)

9.2.3.2* Projections of combustible or projections are wood as defined in NFPA 703, except in any of the following:

9.2.3.2.1* Noncombustible insulation or limited-combustible ceilings are directly attached to the bottoms of solid wood joists so as to create enclosed joint spaces, 160 ft³ (4.5 m³) or less in volume, including space below insulation that is fast directly on top or within the ceiling joists in an otherwise approved attic. See 19.2.2.1.5.2(4).

(5) Concealed spaces over isolated small exterior projections not exceeding 55 ft² (5.1 m²) in area.

M

NOTES

Grid of dots for notes.

NONCOMBUSTIBLE:

- TEMPORARY DROP-OFF = NOT STORAGE
- PARKING = STORAGE

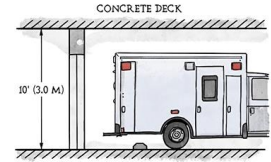

#1 WHETHER SPRINKLERS ARE REQUIRED

- BUILDING CODE
- STANDARD (NFPA 13)
- RECOMMENDED PROTECTION
- CONFIRMED WITH OWNER



NOTES

A large area of the page filled with a grid of small dots, intended for handwritten notes.